

BASED ON IEC 191-20: TYPE 075E06 B  
1. DIMENSIONS

DIMENSIONS IN MILLIMETERS

REVISIONS			
REV	DESCRIPTION	DATE	APPROVED
00	INITIAL RELEASE	2/25/16	J.H

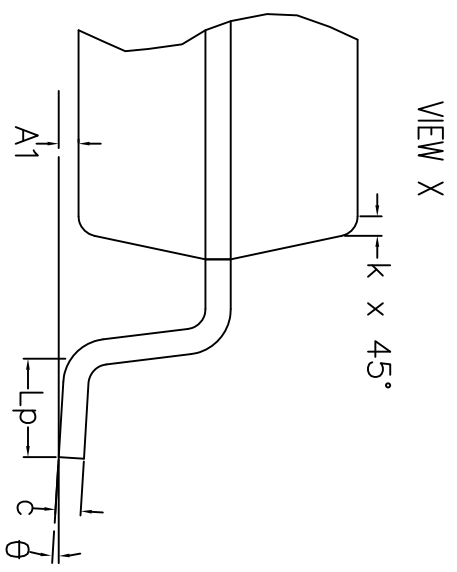
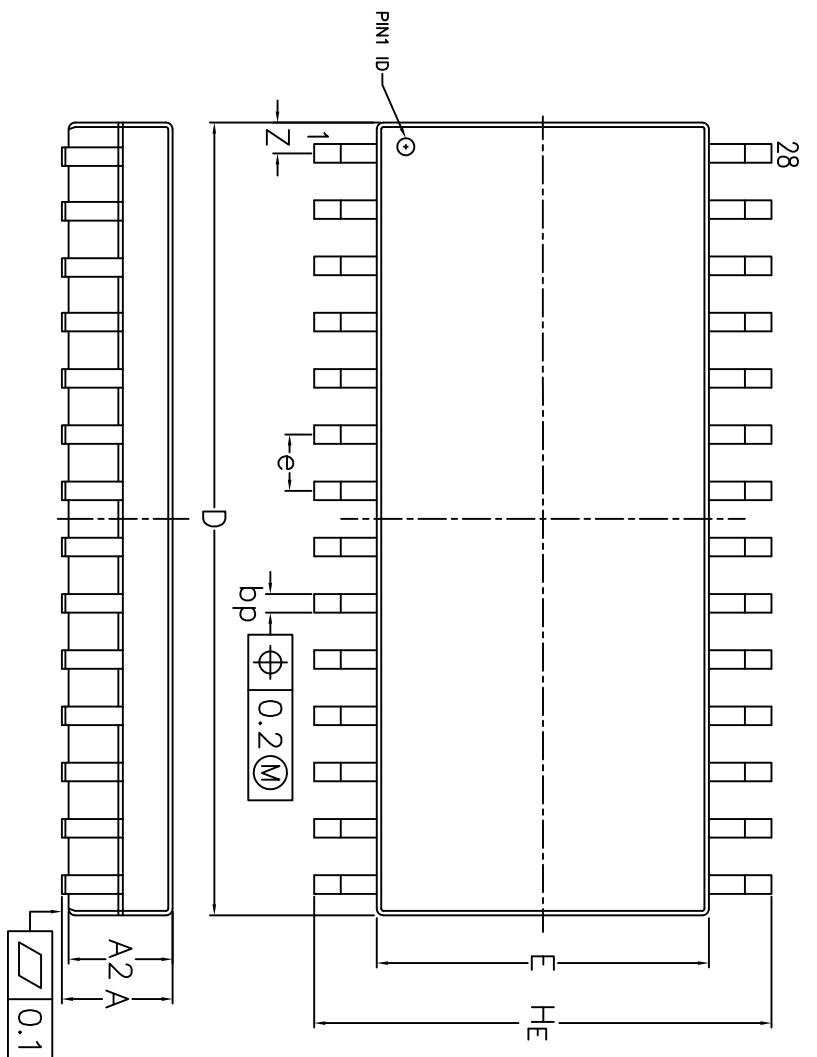

DIMENSIONS OF SUB-GROUP B1	
A max	2.65
bp min	0.35
bp max	0.49
e nom	1.27
He min	10.00
He max	10.65
Lpmin	0.40
Z max	0.81

- WEIGHT  $\leq 0.8$  g
- BODY MATERIAL LOW STRESS EPOXY
- LEAD MATERIAL FeNi-ALLOY or Cu-ALLOY
- LEAD FINISH SOLDER PLATING
- LEAD FORM Z-BENDS

DIMENSIONS OF SUB-GROUP C1	
A min	2.35
A1 min	0.10
A1 max	0.30
A2 min	2.25
A2 max	2.45
c min	0.23
c max	0.32
D min*	17.70
D max*	18.10
E min*	7.40
E max*	7.60
k min	0.25
$\theta$ max	0°
$\theta$ max	8°

TOLERANCES UNLESS SPECIFIED		www.IDT.com	
DECIMAL	ANGULAR	8024 Silver Creek Valley Rd San Jose, CA 95138 PHONE: (408) 284-8200 FAX: (408) 284-3572	
xxx±	±	IDT™	
xxxx±		San Jose, CA 95138	
APPROVALS	DATE	PHONE: (408) 284-8200	
DRAWN	DATE	FAX: (408) 284-3572	
CHECKED		TITLE PSG28 PACKAGE OUTLINE	
		300 mil SOP	
SIZE	DRAWING No.	REV	
C	PSC-4007-03	00	
DO NOT SCALE DRAWING		SHEET 1 OF 1	